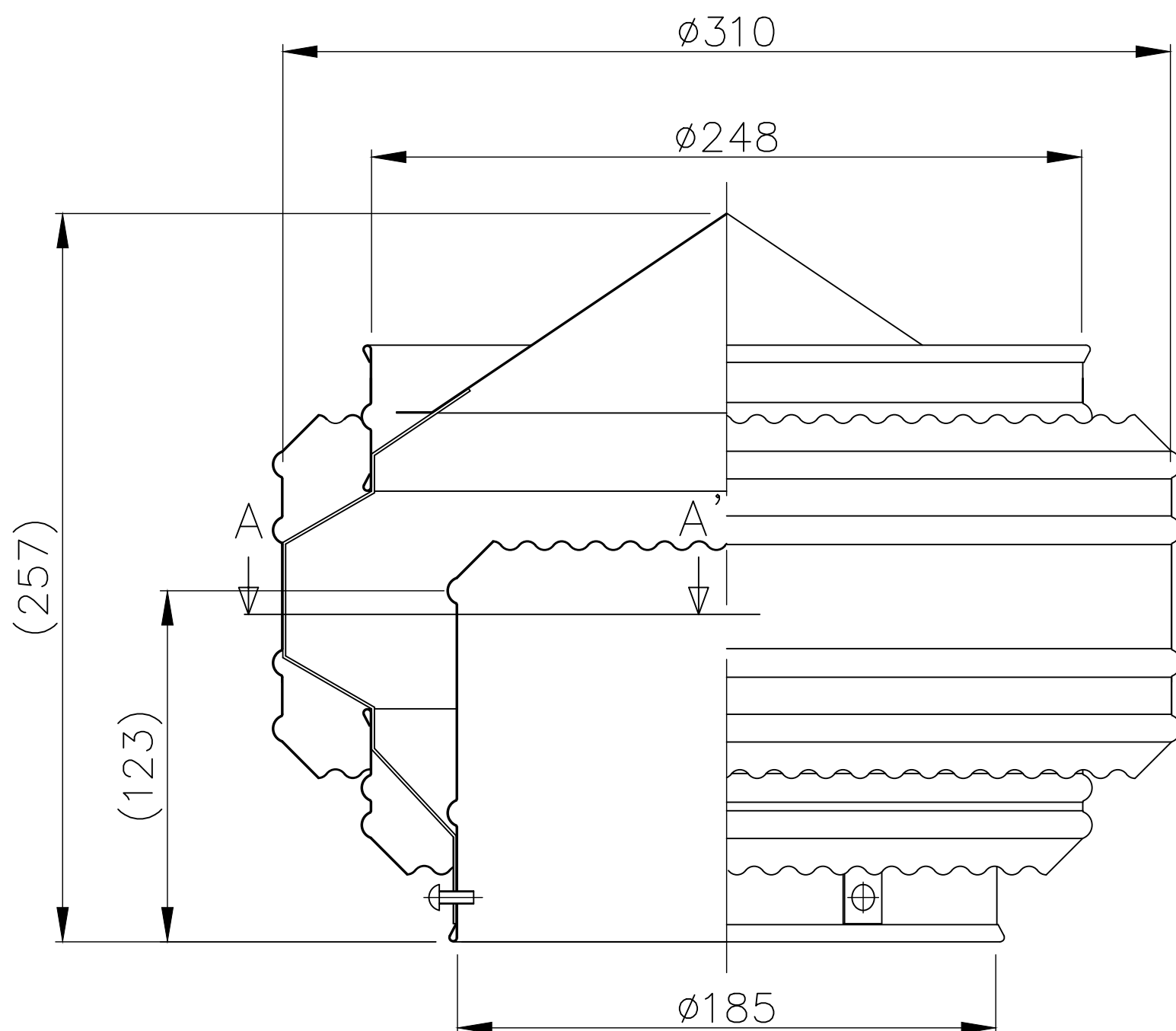

A—A'断面図

This technical drawing shows a cross-section of a gear assembly. It features a central shaft with a gear mounted on it. The gear has a large number of teeth. The assembly is housed within a circular component, likely a housing or a frame, which has a flange on the left side. The drawing is a half-section, with the right half showing the internal structure of the housing and the left half showing the external profile. The gear is positioned on the right side of the shaft, and the housing flange is on the left. The drawing is labeled 'A—A'断面図' (Cross-section A-A').

[illegible]